

## Meetings & Events

---

### Where Defining Moments Begin

Strategically located in a prime spot in Singapore's Civic District and within the CBD, Grand Park City Hall is an ideal choice location for both guest and meeting delegates alike.

Set amidst nature-inspired decor that is in perfect harmony with the surrounding lush greenery, the Rooftop Sky Garden is your perfect venue for outdoor cocktail parties and private events. The meeting room features advanced state-of-the-art equipment and high-speed Internet connectivity to support your event's success.

Our dedicated team of specialists at Grand Park City Hall will deliver exceptional service and innovative ideas to create memorable epicurean moments at your special event.



## Seating Plan(s)

### Rooftop Sky Garden

Level R

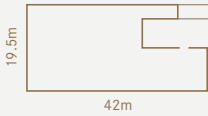

Area (sq-m): 818

### Cocktail Reception

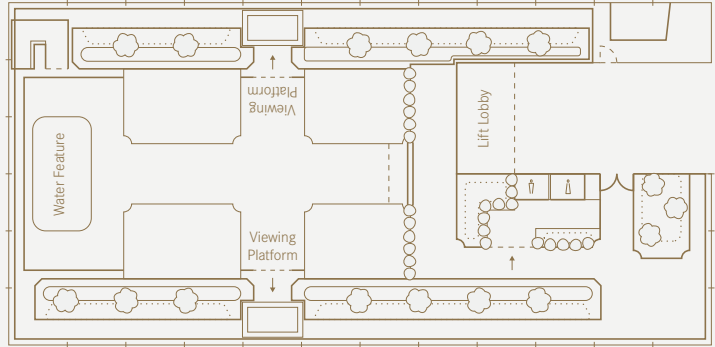

### Private Dining Room

Level 3, Tablescape  
Restaurant & Bar



Area (sq-m): 15

### Boardroom

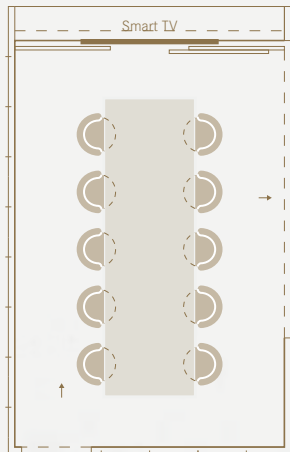

### Theatre

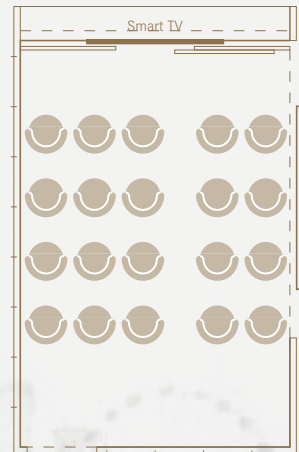

## Seating Plan(s)

### Coleman Meeting Room

Level 3

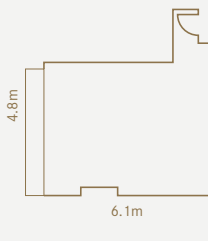

Area (sq-m): 28

### Boardroom

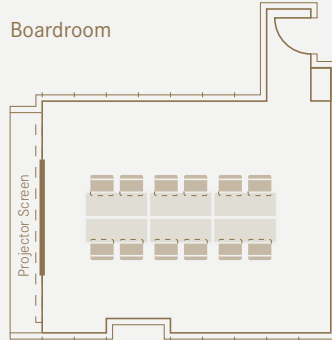

### U-Shape

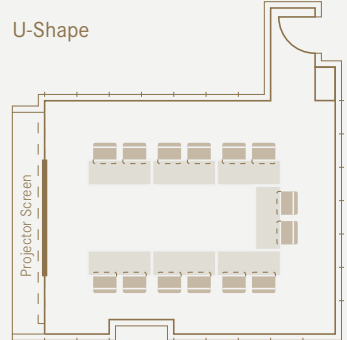

### Cluster

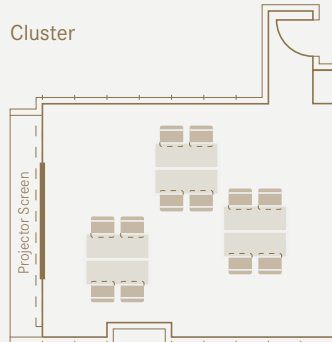

### Classroom

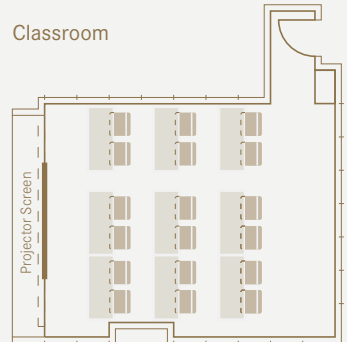

### Theatre

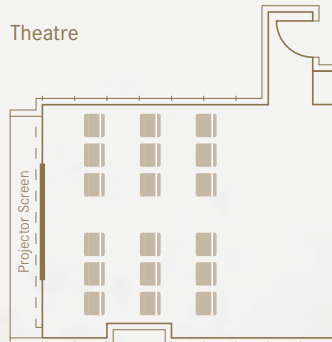

# Meeting Packages

Venue(s)	Package Price (SGD)			Maximum Seating Capacity (pax)					
	½ Day	½ Day +Lunch	Full Day	Cocktail	Theatre	Board room	Class room	Cluster	U-shape
Rooftop Sky Garden	-			180	-	-	-	-	-
Coleman Meeting Room	65++ per pax	85++ per pax	95++ per pax	-	18	12	18	12	14
Private Dining Room				30	20	10	-	-	-

## ½ Day Package

Use of function room from 0900hrs-1300hrs/1300hrs-1700hrs with writing materials, bottled water and mints

Free flow of Coffee and Tea throughout the event

1 Coffee break with 3 snack items

Use of 1 flipchart with markers

Use of LED TV (HDMI)

Complimentary carpark passes based on guaranteed attendance (30% of total guests)

Complimentary Wi-Fi access

## ½ Day Package + Lunch

Use of PDR from 0900hrs-1300hrs/1300hrs-1700hrs with writing materials, bottled water and mints

Free flow of Coffee and Tea throughout the event

1 Coffee break with 3 snack items

Western Set Lunch (3-Course) at Tablescape Restaurant & Bar

Use of 1 flipchart with markers

Use of LED TV (HDMI)

Complimentary carpark passes based on guaranteed attendance (30% of total guests)

Complimentary Wi-Fi access

## Full Day Package

Use of PDR from 0900hrs-1700hrs with writing materials, bottled water and mints

Free flow of Coffee and Tea throughout the event

2 Coffee breaks with 3 snack items each

Western Set Lunch (3-Course) at Tablescape Restaurant & Bar

Use of 1 flipchart with markers

Use of LED TV (HDMI)

Complimentary carpark passes based on guaranteed attendance (30% of total guests)

Complimentary Wi-Fi access